

Xiaomi Outdoor Camera CW300 User Manual



A

1



2



3



4

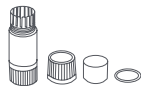

5



6



7



8



9

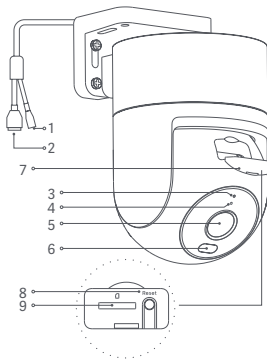
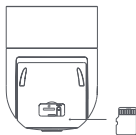
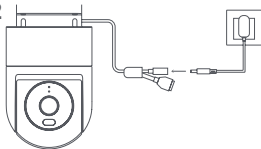

10

B**C-1****C-2**

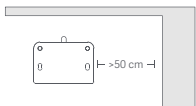
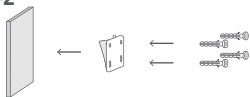
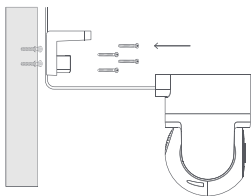
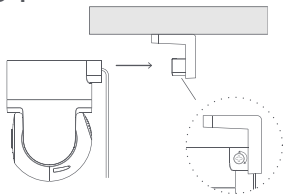
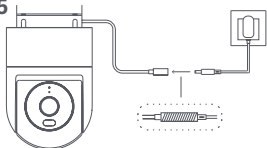
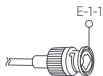
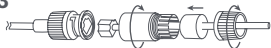
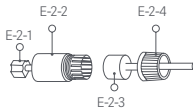
D-1**D-2****D-3****D-4****D-5****E-1****E-3****E-2**

Read this manual carefully before use, and retain it for future reference.

Precautions

- The operating temperature range for this camera is -30°C to 60°C. Do not use this camera in environments with temperatures above or below the specified operating range.
- This camera is a precision electronic product that has an IP66 dust-tight and water-resistant rating. To ensure normal use, do not use the camera in extremely humid environments or locations that may cause water ingress.
- The power adapter that comes along with this product is not waterproof and is only for indoor use. Do not use the power adapter in extremely humid environments or locations that may cause water ingress. The operating temperature range for the power adapter is -30°C to 45°C. Do not use the camera in environments with temperatures above or below the specified range.
- To improve the camera's performance, do not place it where its lens faces or is next to a reflective surface, such as glass windows or white walls, as this will cause the image to appear overly bright in areas close to the camera and darker in areas further away, or cause the camera to produce white images.
- When using Wi-Fi, make sure the camera is installed in an area with a strong Wi-Fi signal. Do not install the camera near microwave ovens and other objects or places that may affect its Wi-Fi signal.
- When enabling or disabling the night vision of the camera, the infrared cut-off filter will be switched and a slight clicking sound will be made, which is normal.
- If the power cable gets damaged, please contact the after-sales service team for replacement.

Product Overview

Package Contents (Fig. A)

1. Xiaomi Outdoor Camera CW300
2. Wall Mount
3. Mounting Template Sticker
4. Power Adapter
5. Waterproof Network Port Accessories
6. Waterproof Tape
7. Mounting Screws
8. User Manual
9. Warranty Notice
10. Attention Sticker

Camera (Fig. B)

1. Power Port
2. Network Cable Port
3. Indicator
4. Microphone
5. Lens
6. Spotlight
7. Waterproof Cover
8. Reset Button
9. microSD Card Slot

Note: Illustrations of product, accessories, and user interface in the user manual are for reference purposes only. Actual product and functions may vary due to product enhancements.

How to Use

Installing a microSD card

Make sure the camera is unplugged. Remove the waterproof cover from over the microSD card slot and insert a microSD card with its contact side facing up. (Fig. C-1)

CAUTION: Unplug the camera when inserting or removing the microSD card. Please use a microSD card from a qualified brand (the camera supports a microSD card with a maximum capacity of 256 GB and the FAT32 format only, and a microSD card with a capacity of 64 GB and above may need to be formatted to the FAT32 format before use via Settings > Manage storage on the camera's plug-in page in the Mi Home/Xiaomi Home app). It is recommended that the microSD card has a read/write speed of no less than U1/Class 10.

Note: After inserting or removing the microSD card, make sure to reinstall the waterproof cover over the card slot to prevent water from entering the camera and affecting normal use.

Turning on

Plug the power adapter cable into the power port on the camera, and the camera will automatically turn on. (Fig. C-2)

When the indicator keeps in orange and a voice notification is heard, the camera is successfully turned on.

Note: Please make sure to use the original power adapter cable provided to charge the camera to avoid the camera not working properly. When the camera is turned on, do not turn the lens of the camera nor force it to rotate. If the positioning of the lens is inaccurate, please calibrate it in the Mi Home/Xiaomi Home app.

Indicator Status

Orange: Awaiting connection/Reset successfully

Blinking orange: Connecting to a network...

Blinking blue: Connecting to a server/OTA update in progress...

Blue: Connected successfully/Working normally

Connecting with the Mi Home/Xiaomi Home App

This product works with the Mi Home/Xiaomi Home app*. Use the Mi Home/Xiaomi Home app to control your device, and to interact with other smart home devices. Scan the QR code to download and install the app. You will be directed to the connection setup page if the app is installed already. Or search for "Mi Home/Xiaomi Home" in the app store to download and install it. Open the Mi Home/Xiaomi Home app, tap "+" on the upper right, and then follow the instructions to add your device.



10F1A6C2

Notes: The version of the app might have been updated, please follow the instructions based on the current app version. When connecting, make sure the network connection is stable, the camera is turned on, and the indicator remains orange. Once connected, the indicator will change to blue.

* The app is referred to as Xiaomi Home app in Europe (except for Russia). The name of the app displayed on your device should be taken as the default.

Reset

Press and hold the reset button for about 7 seconds if changing the network or the Xiaomi account connected to the camera. A voice notification will be heard once the reset is completed.

Note: Resetting the camera will not delete any data on the microSD card.

Installation

1. Stick the mounting template sticker in the correct position on the wall, making sure the right side of the sticker is over 50 cm from the corner of the wall. Drill holes in the wall that align with the holes on the sticker, with a diameter of about 6 mm and a depth of about 35 mm. (Fig. D-1)
2. Insert the plastic wall plugs into the drilled holes. (Fig. D-2)
3. Wall-mounted installation: Attach the wall mount to the wall by inserting the screws into the holes and screwing them into the wall plugs. If the power cable is being installed upward, it should pass through the groove in the wall mount first before the wall mount is screwed onto the wall. (Fig. D-3)
4. Ceiling installation: Turn the base of the camera upward, line it up with the clip on the mounting bracket, and tighten the screw on the right side. (Fig. D-4)
5. Once the camera is secured in place, wrap the waterproof tape around the power port to avoid water ingress. (Fig. D-5)

CAUTIONS:

- The wall must be able to support at least three times the total weight of the camera.
- To prevent possible injury, the camera must be securely fixed to the wall according to the installation instructions.
- Do not install near a heat source, such as an outdoor air conditioning unit, range hood outlet, or gas water heater outlet.

Installing the waterproof network port accessories

E-1-1. Sealing Ring

E-2-2. Waterproof Sleeve

E-2-4. Waterproof Rear

E-2-1. Network Cable

E-2-3. Stopper

Cover

The waterproof network port accessories include: sealing ring, waterproof sleeve, stopper, and waterproof rear cover. Once installed, the network port's waterproof performance will be improved. Place the sealing ring on the camera's network port (Fig. E-1). Thread the waterproof rear cover, stopper, and waterproof sleeve over the network cable in order (Fig. E-2), then plug the network cable into the port. Screw together the waterproof sleeve and sealing ring, then screw together the waterproof rear cover and waterproof sleeve (Fig. E-3).

When network cable is not used, please still install the waterproof network port accessories.

Please use a shielded network cable.

Specifications

Name: Xiaomi Outdoor Camera CW300

Item Dimensions: 168 × 100 × 123 mm

Night Vision Light: 850 nm infrared light × 2, white light × 2

Wireless Connectivity: Wi-Fi IEEE 802.11 b/g/n 2.4 GHz

Wi-Fi Operation Frequency: 2412–2472 MHz

Wi-Fi Maximum Output Power: <20 dBm

Storage: MicroSD card (8 GB–256 GB supported)/Cloud storage

Operating Temperature: -30°C to 60°C

Model: MBC21

Video Codec: H.265

Rated Input: 12V=1A

Net Weight: 487 g

Resolution: 2560 × 1440

WEEE Information



All products bearing this symbol are waste electrical and electronic equipment (WEEE as in directive 2012/19/EU) which should not be mixed with unsorted household waste. Instead, you should protect human health and the environment by handing over your waste equipment to a designated collection point for the recycling of waste electrical and electronic equipment, appointed by the government or local authorities. Correct disposal and recycling will help prevent potential negative consequences to the environment and human health. Please contact the installer or local authorities for more information about the location as well as terms and conditions of such collection points.

EU Declaration of Conformity



Hereby, Shanghai Moshon Technology Co., Ltd. declares that the radio equipment type Xiaomi Outdoor Camera CW300 (product name) MBC21 (model) is in compliance with Directive 2014/53/EU. The full text of the EU declaration of conformity is available at the following internet address: <http://www.mi.com/global/service/support/declaration.html>

Under normal use of condition, this equipment should be kept a separation distance of at least 20 cm between the antenna and the body of the user.



CAUTION: Possibly hazardous optical radiation emitted from this product. Do not stare at operating lamp. May be harmful to the eyes.



Note: The power adapter is not waterproof and is only for indoor use. Do not use it in extremely humid environments or locations that may cause water ingress.

Manufactured for: Xiaomi Communications Co., Ltd.
Manufactured by: Shanghai Moshon Technology Co., Ltd.
(a Mi Ecosystem company)

Address: No. 668 Shenzhuan Road, Songjiang Hi-Tech
Park, Caohejing Development Zone, Shanghai, China

For further information, please go to www.mi.com

User Manual Version: V1.0

Importer:
Beryko s.r.o.
Pod Vinicemi 931/2, 301 00 Plzeň
www.beryko.cz

Complies with
IMDA Standards
DB106135

