

# Xiaomi Smart Camera C500 Pro User Manual



Read this manual carefully before use, and retain it for future reference.

## Product Overview

---

The nameplate is marked on the bottom of the camera.

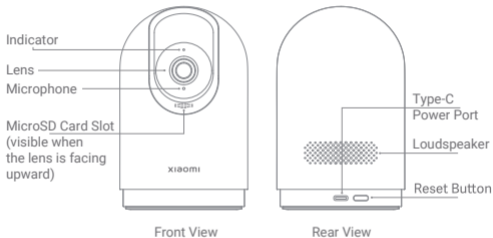

**Note:** Illustrations of product, accessories, and user interface in the user manual are for reference purposes only. Actual product and functions may vary due to product enhancements.

**Package Contents:** Xiaomi Smart Camera C500 Pro, charging cable, wall mounting kit, user manual, warranty notice

## How to Install

---

The camera can be placed on flat surfaces, such as desks, dining tables, and coffee tables. It can also be mounted on a wall.

Mounting the Camera on a Wall:

1. First use a pencil to mark the positions for the base mounting holes on the wall, then drill two holes at the marked positions. The diameter of each hole is approximately 6 mm, and the depth is approximately 30 mm.
2. Insert the plastic wall plugs into the drilled holes.
3. Place the side of the base with arrows facing outward, then align the holes. Insert the screws and then tighten them into the wall plugs with a Phillips head screwdriver.
4. Align the grooves on the bottom of the camera with the raised part on the base, then turn it clockwise until it locks into place.

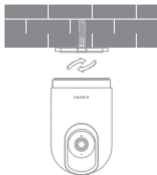
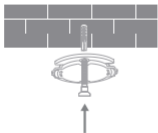

 Precaution for Mounting the Camera on a Wall

The wall must be able to support at least three times the total weight of the camera.

 WARNINGS

The camera must be securely fixed to the ceiling or wall according to the installation instructions to prevent possible injury.

## How to Use

---

- Installing a MicroSD Card

Make sure that the power to the camera is already disconnected. Adjust the lens upward until the microSD card slot is revealed, then insert the microSD card into the slot (the side with contact points must be facing down).

Unplug the camera when installing or removing the microSD card. Please use a microSD card (a minimum capacity of 8 GB and above, and a maximum capacity of 256 GB and below) from a qualified brand . It is recommended that the microSD card has a read/write speed of no less than U1/Class 10.

## Turning On

Plug the charging cable into the Type-C power port on the back of the camera, the camera automatically turns on, and the indicator quickly blinks orange.

Note: When the camera is working, do not turn the camera nor force it to rotate. If the positioning of the lens is inaccurate, please calibrate it in the Mi Home/Xiaomi Home app.

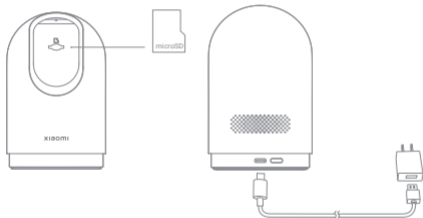

- Indicator

Keeping blue: Connected successfully/Working normally

Blinking blue: Network error

Blinking orange quickly: To be connected

Blinking orange slowly: Updating

Note: Please make sure to use the LPS adapter cable for connection to avoid abnormal operations.

## Connecting with the Mi Home/Xiaomi Home App

---

This product works with the Mi Home/Xiaomi Home app\*. Control your device with Mi Home/Xiaomi Home app. Scan the QR code to download and install the app. You will be directed to the connection setup page if the app is installed already. Or search for "Mi Home/Xiaomi Home" in the app store to download and install it. Open the Mi Home/Xiaomi Home app, tap "+" on the upper right, and then follow the instructions to add your device.



F61E1A4F

\* The app is referred to as Xiaomi Home app in Europe (except for Russia). The name of the app displayed on your device should be taken as the default.

Note: The version of the app might have been updated, please follow the instructions based on the current app version. Make sure the camera turns on and the network connection is stable during connecting. The indicator is quickly blinking orange when waiting for a connection, and turns into blue once the camera is successfully connected.

- Restoring Factory Settings

In case of changing the network that the camera is connected to or the Xiaomi Account in the Mi Home/Xiaomi Home app that the camera is paired with, press and hold the reset button for about 7 seconds. Once the indicator blinks orange quickly, the camera is restored to factory settings, and then reconnect the camera with the Mi Home/Xiaomi Home app.

Note: Restoring factory settings will not delete the content on the microSD card.

## Real-time Surveillance

---

In the camera's plugin of the Mi Home/Xiaomi Home app, you can view the real-time surveillance screen, adjust the sharpness of the image, change the horizontal and vertical angle of the camera, capture and record the screen, and make remote calls.

## Infrared Night Vision

---

The camera can automatically switch to night vision mode at night according to the change in ambient light. With built-in infrared night vision lights, the camera can clearly capture images/videos in the dark. For the automatic turning on of the night mode, complete darkness is required, otherwise, the night vision may not be automatically turned on.

## Playback

---

- The playback feature of the camera is only available when a compatible microSD card is installed or a cloud storage service is purchased for the camera.
- In the camera's plugin of the Mi Home/Xiaomi Home app, tap the playback button to enter the playback interface, then drag the timeline to select the time period to be played back. Variable speed playback is supported.

## Automatic Surveillance

---

- When the home surveillance assistant feature is enabled, the camera will record videos if it detects human movement and changes in real-time within its monitored area. Then you will get the app push notification.
- You can enable or disable the home surveillance assistant feature in the camera's plugin of the app.
- You can set surveillance of all-day, daytime, nighttime, or any other time meeting your demands. Alert sensitivity and alert time intervals can also be customized in the app.

## Area Surveillance

---

- When the area surveillance feature is enabled, the camera will set specific surveillance scenes for family members, such as "key areas monitoring" and "no motion detected for a long time" scenes. Users can edit the surveilled areas and set the surveillance time. After the settings are completed, when events like someone entering the key area occur, you will get the app notification to get the status of family members in time.
- You can enable or disable the area surveillance feature via AI features page on the camera's plugin homepage in the Mi Home/Xiaomi Home app.



## Video Sharing

---

In the camera's plugin of the Mi Home/Xiaomi Home app, you can select the device sharing option in the settings menu to share the camera with others. The person the camera is shared with needs to download the Mi Home/Xiaomi Home app and sign in with a Xiaomi Account.

## Physical Lens Blocking

---

When you don't need to use the camera, you can tap "  " on the real-time footage screen of the camera's plugin in the Mi Home/Xiaomi Home app to enter the physical lens blocking status. You can also go to Settings > Camera settings > Physical lens blocking settings to enable the physical lens blocking feature or set scheduled automatic physical lens blocking. The camera will automatically adjust the lens so that it is covered by the casing of the camera itself to protect the user's privacy.



## Specifications

---

Name: Xiaomi Smart Camera C500 Pro

Net Weight: Approx. 301 g

Item Dimensions: 124 × 78 × 78 mm

Resolution: 2960 × 1666

Operating Temperature: -10°C to 40°C

Wireless Connectivity: Wi-Fi IEEE 802.11 a/b/g/n 2.4 GHz/5 GHz,  
Bluetooth 5.2

Storage: MicroSD card (a minimum capacity of 8 GB and above, and a maximum capacity of 256 GB and below)

Wi-Fi Maximum Output Power:

2400–2483.5 MHz, <20 dBm

5150–5350 MHz, <23 dBm

5470–5725 MHz, <23 dBm

5725–5850 MHz, <14 dBm

Bluetooth Maximum Output Power: 2402–2480 MHz, <10 dBm

Model: MJSXJ16CM

Input: 5 V ⎓ 2 A

Video Codec: H.265

## Cautions

---

- The operating temperature range for this camera is between -10°C and 40°C. Do not use the camera in environments with temperatures above or below the specified range.
- The camera is a precision electronic product. In order to ensure its normal operation, do not install the camera in environments with high humidity levels nor allow water to get into it.
- To ensure the camera's performance, do not place its lens facing or next to a reflective surface, such as glass windows or white walls, as this will cause the image to appear overly bright in areas close to the camera and darker in areas further away, or cause the camera

- to produce white images.
- Make sure the camera is installed in an area with a strong Wi-Fi signal. Do not place the camera near objects that may affect its Wi-Fi signal, such as metal objects and microwave ovens.
  - Under normal use of condition, this equipment should be kept a separation distance of at least 20 cm between the antenna and the body of the user.

## WEEE Information

---



All products bearing this symbol are waste electrical and electronic equipment (WEEE as in directive 2012/19/EU) which should not be mixed with unsorted household waste. Instead, you should protect human health and the environment by handing over your waste equipment to a designated collection point for the recycling of waste electrical and electronic equipment, appointed by the government or local authorities. Correct disposal and recycling will help prevent potential negative consequences to the environment and human health. Please contact the installer or local authorities for more information about the location as well as terms and conditions of such collection points.

## EU Declaration of Conformity

---

 Hereby, Shanghai Imilab Technology Co., Ltd. declares that the radio equipment type Xiaomi Smart Camera C500 Pro is in compliance with Directive 2014/53/EU. The full text of the EU declaration of conformity is available at the following internet address: <http://www.mi.com/global/service/support/declaration.html>

**Restrictions in the 5 GHz band:**

According to Article 10 (10) of Directive 2014/53/EU, the packaging shows that this radio equipment will be subject to some restrictions when placed on the market in Belgium (BE), Bulgaria (BG), the Czech Republic (CZ), Denmark (DK), Germany (DE), Estonia (EE), Ireland (IE), Greece (EL), Spain(ES), France (FR), Croatia (HR), Italy (IT), Cyprus (CY), Latvia (LV), Lithuania(LT), Luxembourg (LU), Hungary (HU), Malta (MT),Netherlands (NL), Austria(AT), Poland (PL), Portugal (PT), Romania (RO), Slovenia (SI), Slovakia (SK), Finland(FI), Sweden (SE), Türkiye (TR), Norway(NO), Switzerland (CH), Iceland (IS), Liechtenstein (LI), and Northern Ireland (NI).

The WLAN function for this device is restricted to indoor use only when operating in the 5150-5250/5250-5350 MHz frequency range.

	BE	EE	HR	IT	CY	LV	LT
	BG	IE	LU	HU	MT	NL	AT
	CZ	EL	PL	PT	RO	SI	SK
	DK	ES	FI	SE	DE	FR	LI
	NO	IS	CH	TR	UK(NI)		

Manufactured for: Xiaomi Communications Co., Ltd.

Manufactured by: Shanghai Imilab Technology Co., Ltd.

(a Mi Ecosystem company)

Address: Room 001A, Floor 11, Block 1, No. 588 Zixing Road, Minhang District, Shanghai, China

For further information, please go to [www.mi.com](http://www.mi.com)

User Manual Version: V1.3

Importer:

Beryko s.r.o.

Pod Vinicemi 931/2, 301 00 Plzeň

[www.beryko.cz](http://www.beryko.cz)